

“Say Dez!”[®]

Beginners' Driver Education (B.D.E.) E-Curriculum



TABLE OF CONTENTS

Chapter 1 COURSE INFORMATION

pg 03 | course overview
pg 04 | course content

Chapter 2 GETTING STARTED

pg 05 | choose course
pg 06 | review content
pg 07 | review walkthrough
pg 08 | login
pg 09 | username & password
pg 10 | confirm ‘not a bot’
pg 11 | password reset

Chapter 3 YOUR ACCOUNT

pg 12 | course progress
pg 13 | course expiry
pg 14 | bottom menu
pg 15 | support
pg 16 | terms & conditions
pg 17 | privacy policy
pg 18 | start course

Chapter 4 MODULES

pg 19 | choose module
pg 20 | view slides
pg 21 | review content
pg 22 | mark complete
pg 23 | no skipping
pg 24 | take test
pg 25 | confirm ID
pg 26 | start test

Chapter 4 TRAINING NOTES

pg 27 | how to pause
pg 28 | continue session
pg 29 | breaks
pg 30 | auto logout
pg 31 | random validation
pg 32 | daily limit

Chapter 5 COURSE COMPLETION

pg 33 | feedback



Welcome to the
“Say Dez!”®
Beginners’ Driver Education
(B.D.E.) E-Curriculum

“Experiential” instruction is defined in this manner:

“One of five (5) things that make adult learning different from pedagogy is that adults learn better when they experience what they are learning. Experiential learning refers to the types of education that allows adults to be active, to do whatever they are learning.

They also want to apply their new learnings to life wisdom they have already have from their accumulation of experiences.

Experiential means education that involves or relates to experience.”

This is by Deb Peterson, a language professor.

However the “Experiential” is difficult to evaluate. Why? You as the student is just learning to drive therefore your driving experiences may not be sufficient to provide a feedback.

But here is a wonderful quote from John Wesley (1703 – 1791), an Englishman and Evangelist, founder of Methodism. The quote is “If you cannot experience it, it is probably not true.”

The danger of asking you the student to turn in homework projects may border on collecting fiction. To prevent this from happening, there are several opportunities where you may learn by experience. This is the challenge for “Experiential” learning.

There is a serious question you need to ask yourself. “Why do you wish to learn to drive?” The answer may surprise you in its simplicity. Driving is a selfish activity. You are doing it for yourself. It will bolster your independence, give you freedom from relying on others. When you learn to drive, learn it well. Ask yourself this philosophical question: “Who are my three best friends?” Again the answer is straightforward. Your three best friends are: “Me, myself and I” in first person singular. Like yourself, and make an honest effort in learning to drive, otherwise you are wasting your time and may endanger yourself and others.

Enjoy and learn. The Beginners Driver Education (B.D.E.) E-Curriculum by “Say Dez!”® consists of twenty (20) hours of “E” (on-line) learning classroom training in ten (10) modules of two (2) hours each plus a final test of your knowledge.

The “Say Dez!”® (BDE) E-Curriculum topics:

- Expectations
- PowerPoint presentations for each lesson
- Videos embedded into the PowerPoint presentations

Keep Smiling,

Dez Miklós



Say Dez!®



COURSE OUTLINE FOR **THE BEGINNER DRIVER EDUCATION** E-CURRICULUM

The eleven (11) modules cover the following topics:

#1 Rules & Regulations

- Graduated Licensing
- MTO's Goals
- Demerit Point
- Right Of Way
- Control Devices
- Traffic Lights
- Stop Signs Protocol
- Flashing Lights
- Unknown Signs
- Insurance

#2 Physical Health

- Attitude
- Distractions
- Health
- Division Of Attention
- Vaping
- Multiple Organ and Tissue Donation

#3 Alcohol & Drugs

- Drugs
- The Pot & Driving Campaign
- Glue & Inhalant Sniffing
- Alcohol
- Science Experiment

#4 SPIDE & Vehicle Knowledge

- Understanding Your Car

- Auto Transmission & The Parking Pawl
- Automobile Lights
- Tires
- S.I.P.D.E.

#5 Urban Roads & Parking

- Turns
- Parking – Parallel
- Parking – Angle
- Oddities
- Bicycles
- HOV / HOT Lanes

#6 Rural Roads & Expressways

- Country Roads
- Slow Moving Vehicles (SMV)
- Volunteer Fire Fighters (VFF)
- Expressway
- Traffic Jams
- Trucks
- Toll Roads

#7 Laws Of Physics

- Laws Of Physics
- Hazard Perception
- Technologies
- Line Of Least Resistance
- Math Forum

#8 Adversities & Emergencies

- Adverse Conditions
- Animals
- Trains
- Emergencies

#9 Things That You Ought To Know

- Auto\$mart
- Alternate Fuels
- 10 Myths

#10 Final test

- Chronology of Crossings
- Crossword
- Final Test

#11 Home Link

- Introduction
- Vehicle Components
- Deaf Drivers
- Ergonomics
- Obesity & Driving
- Mental Disorder
- Addiction by Gábor Máté
- Fundamentals of Trailing
- Collision Management
- Intersection Observation
- Independent Driving

Choose Your Course



Review Introduction

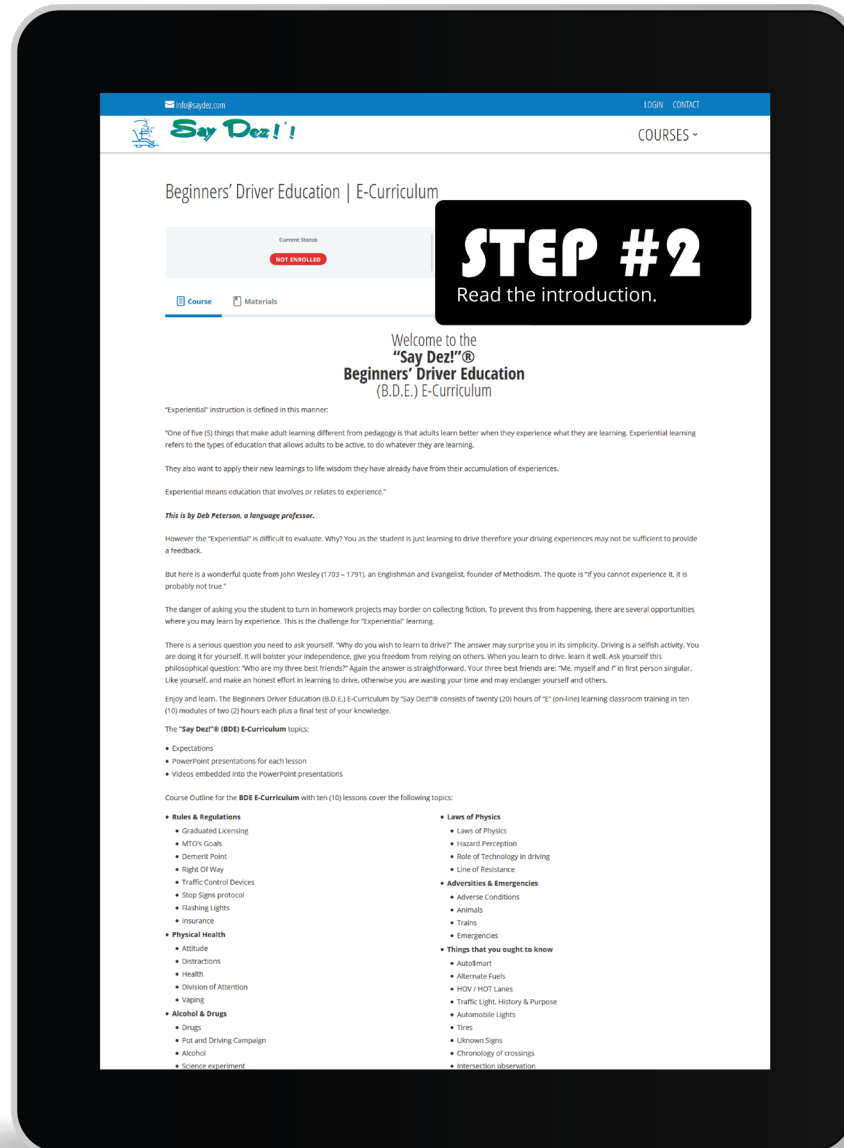

Review Walkthrough Material

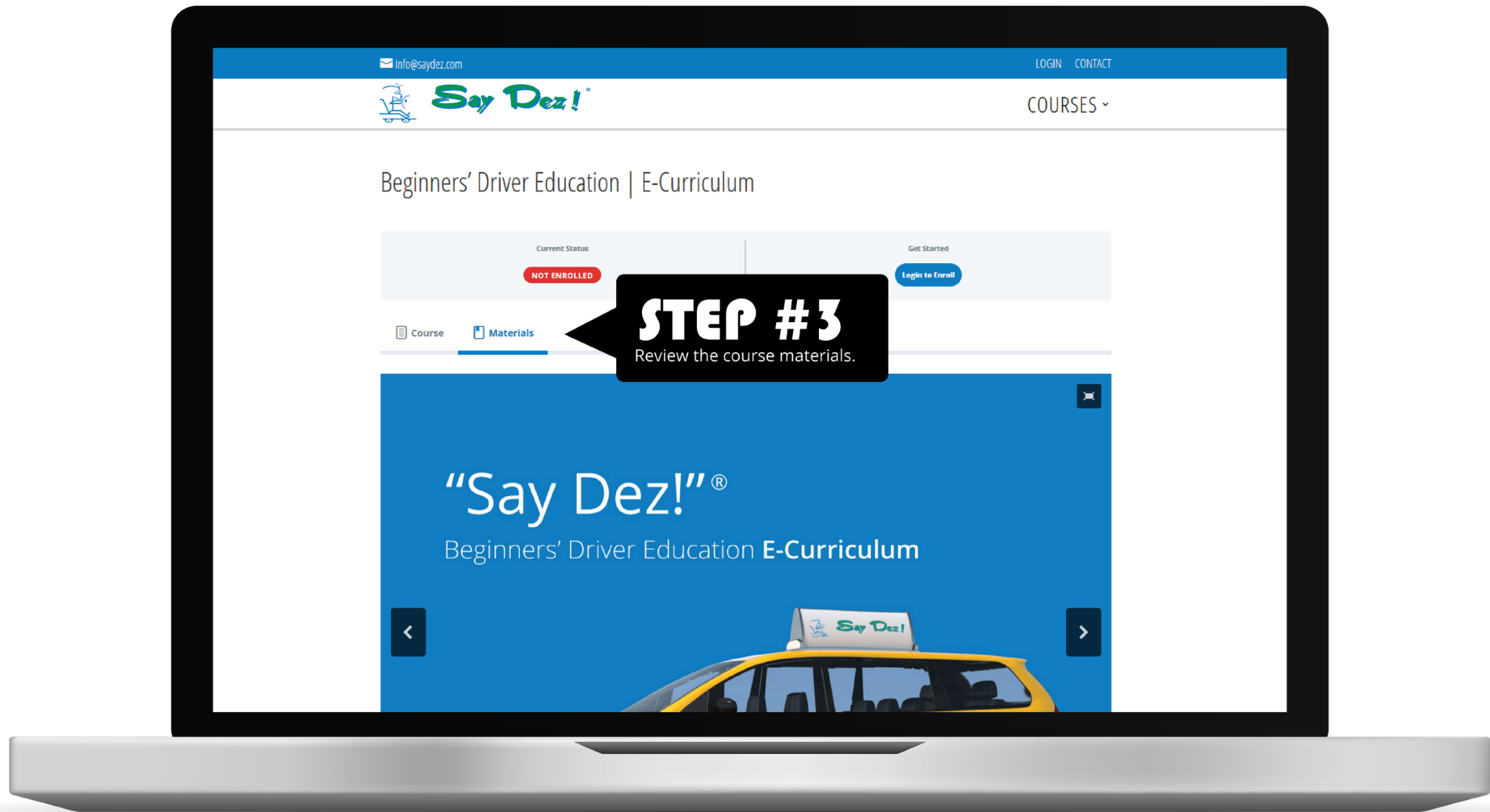

How To Login

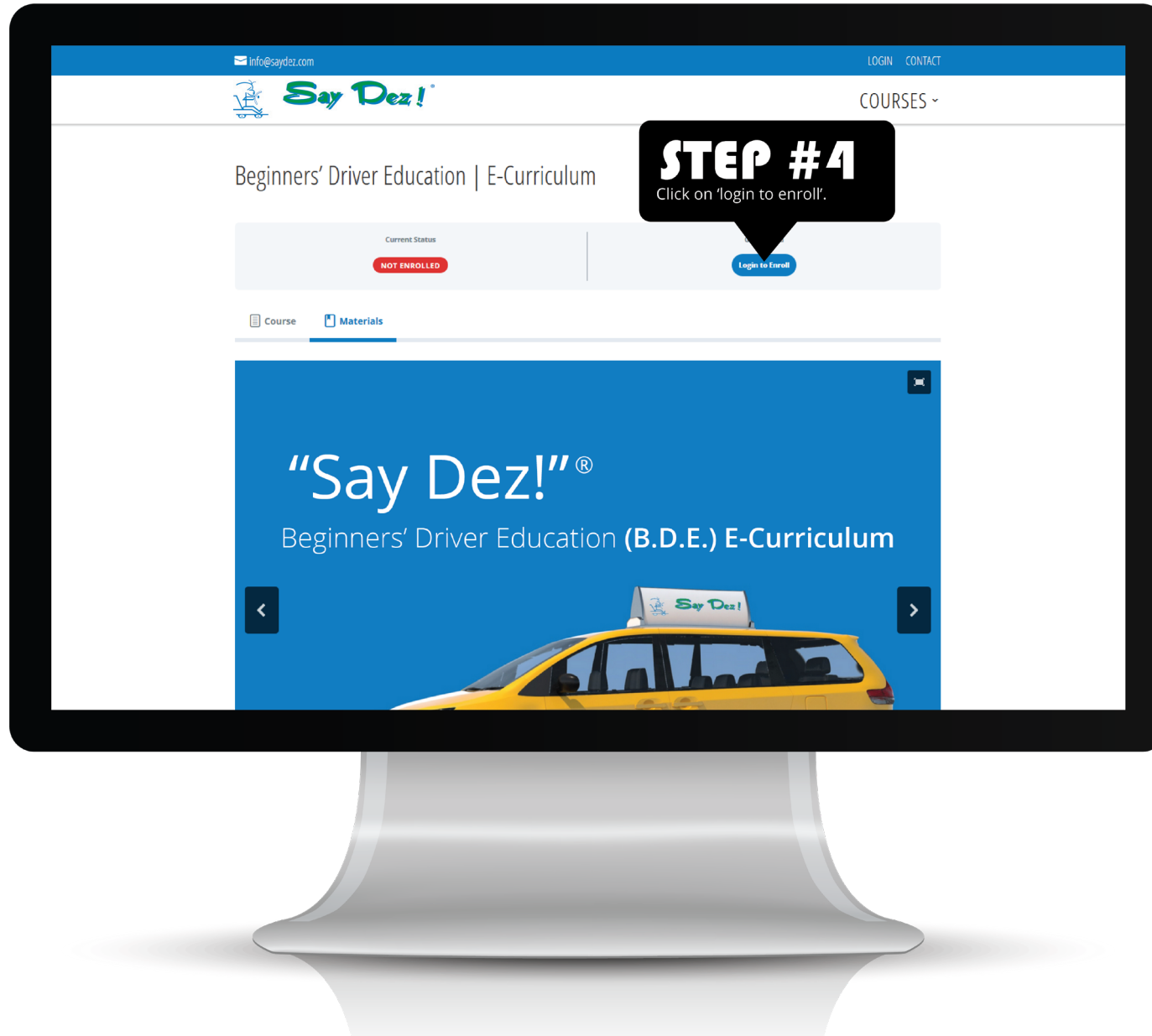

Enter Username & Password

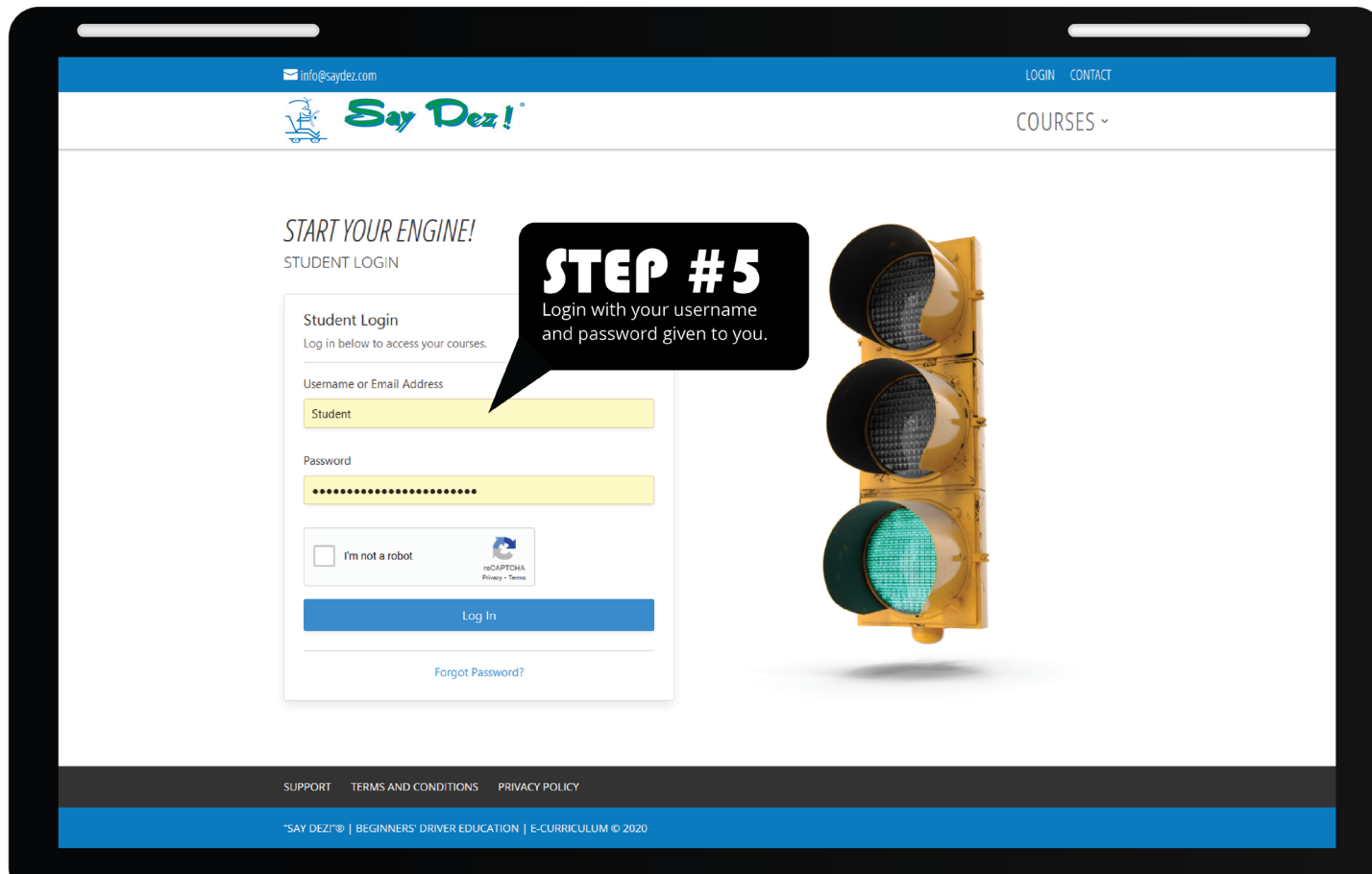

Confirm 'not a bot'

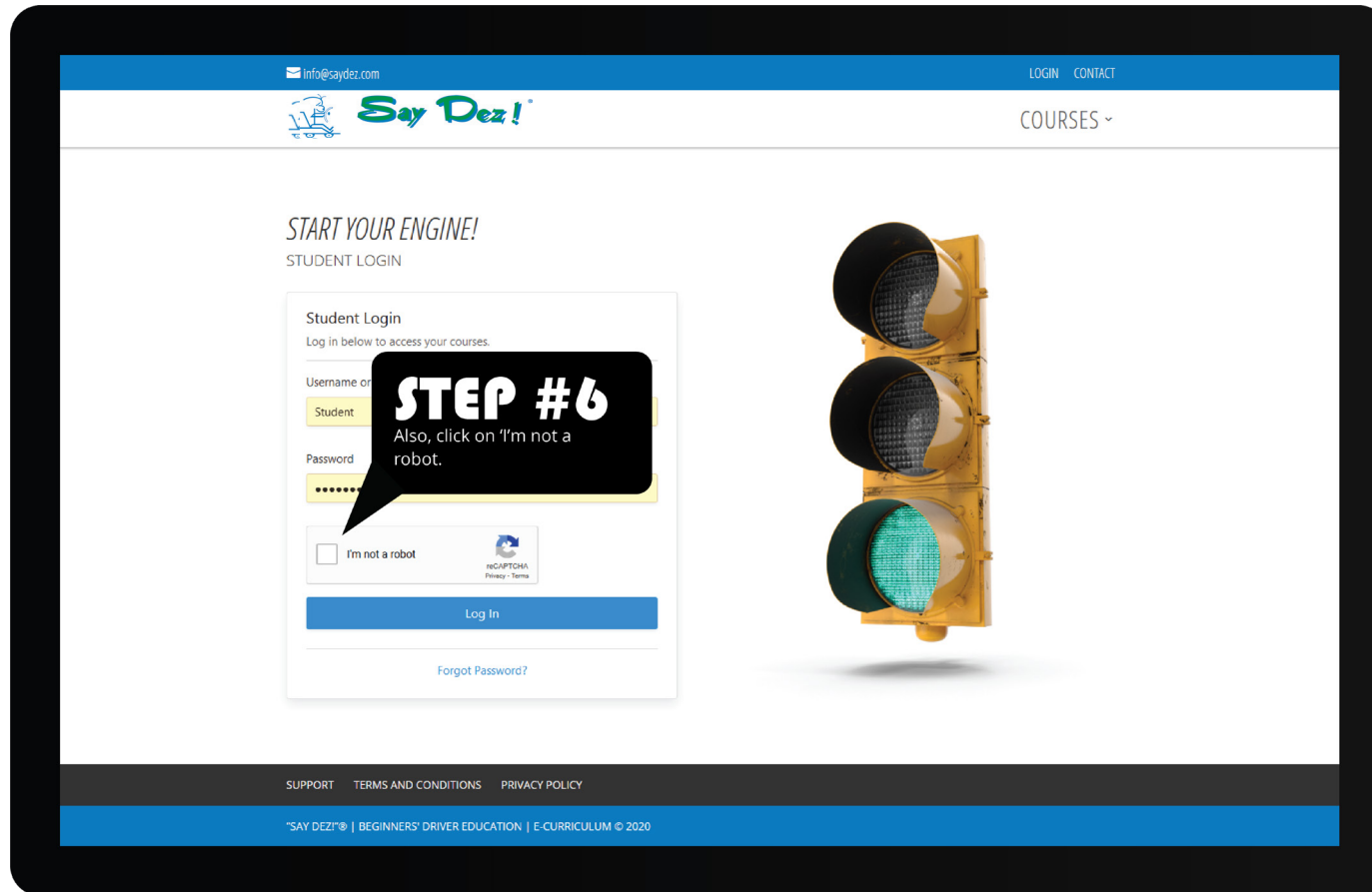

Password Reset

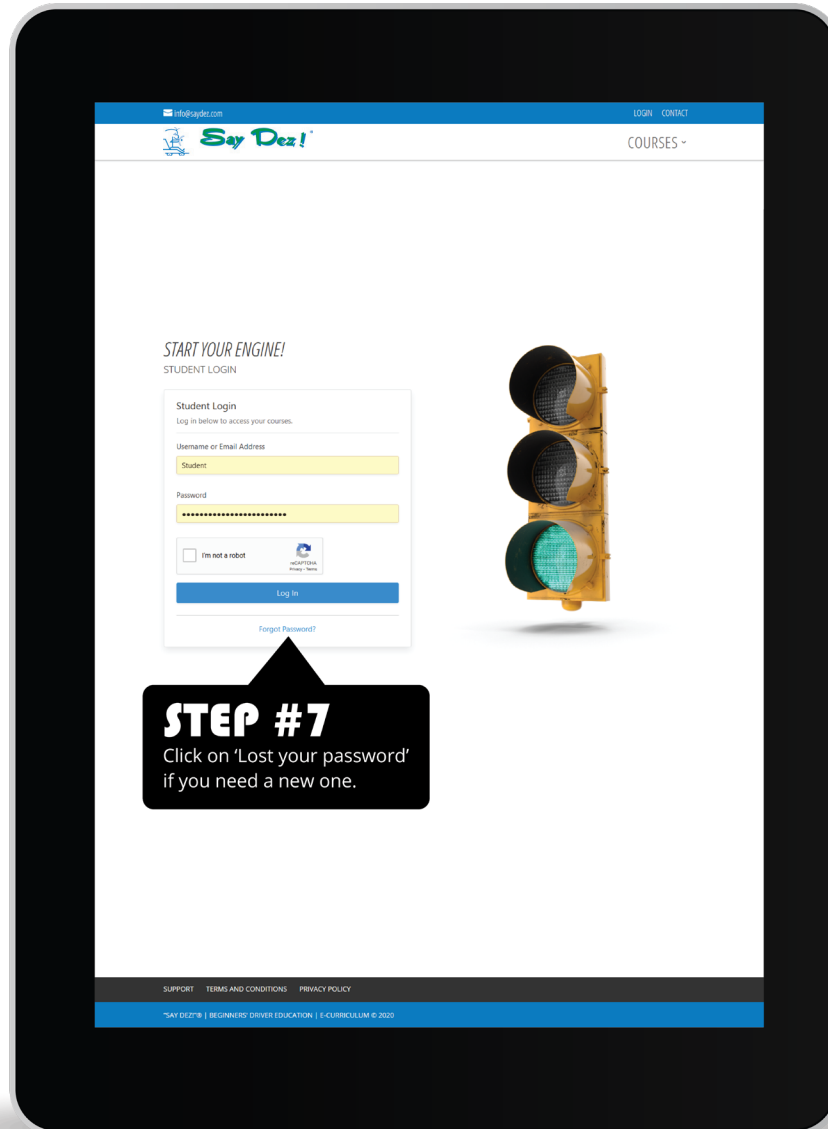

Course Progress

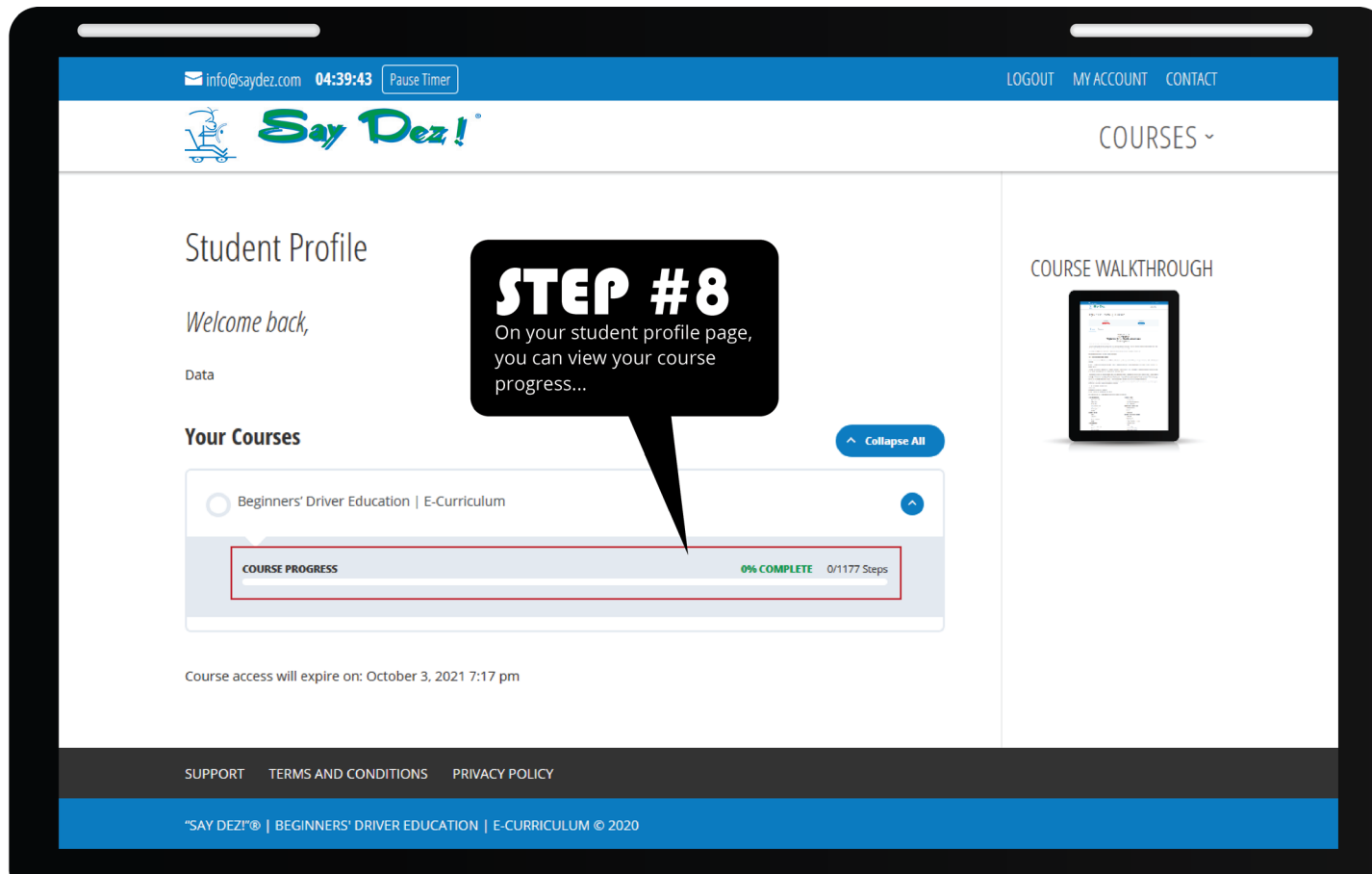

Course Expiry

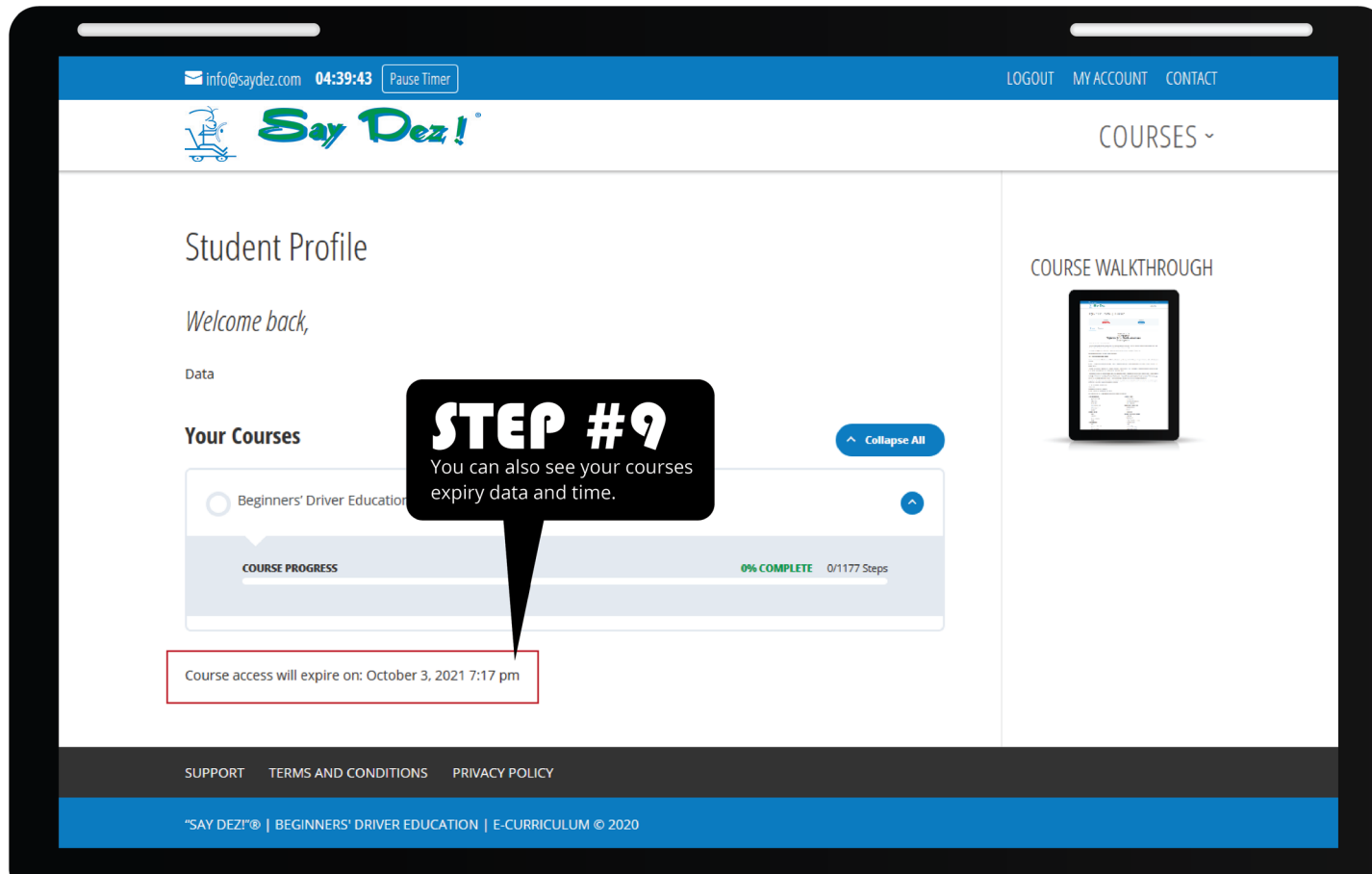

Support, Terms, & Privacy

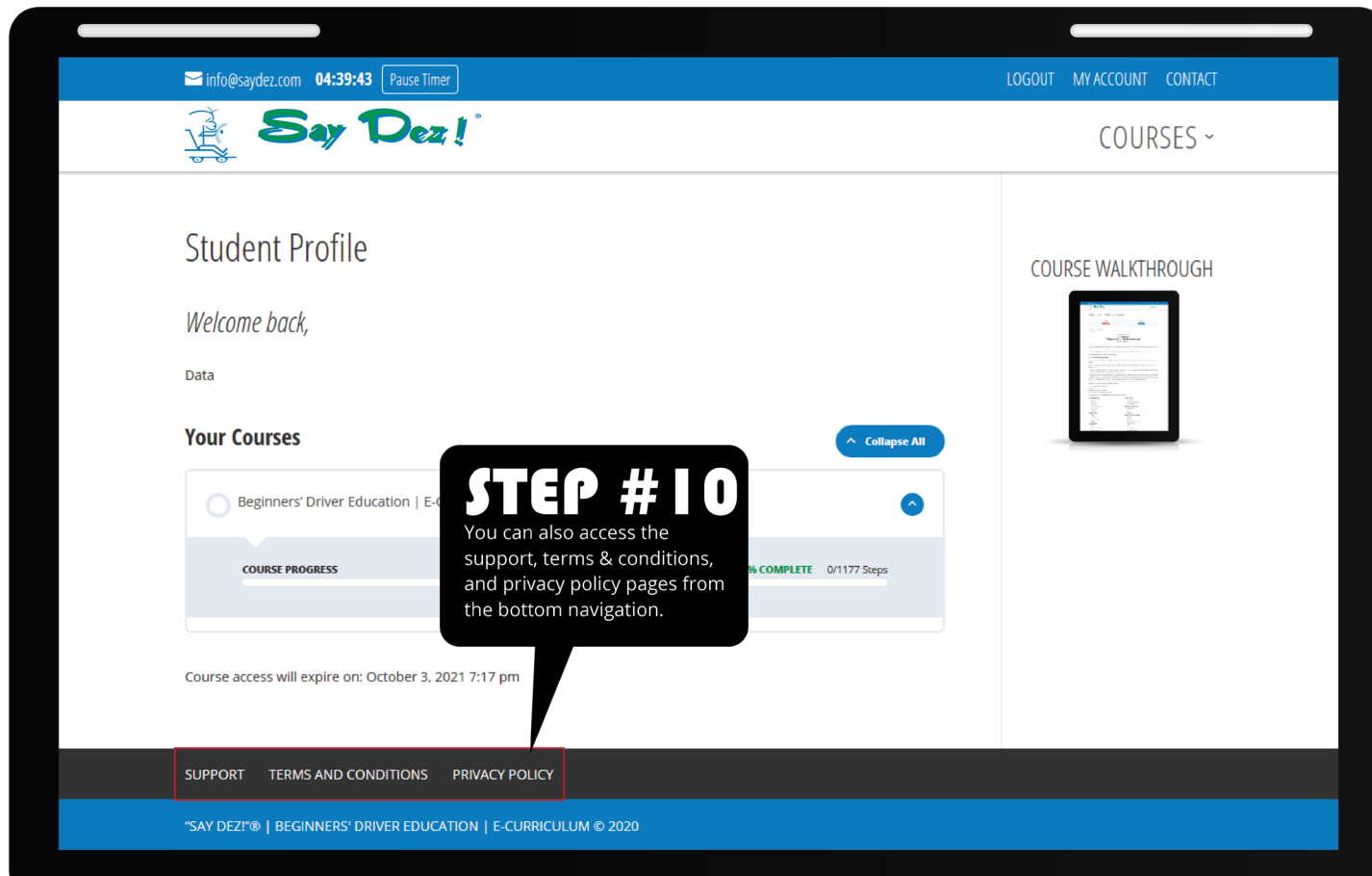

Need Help?

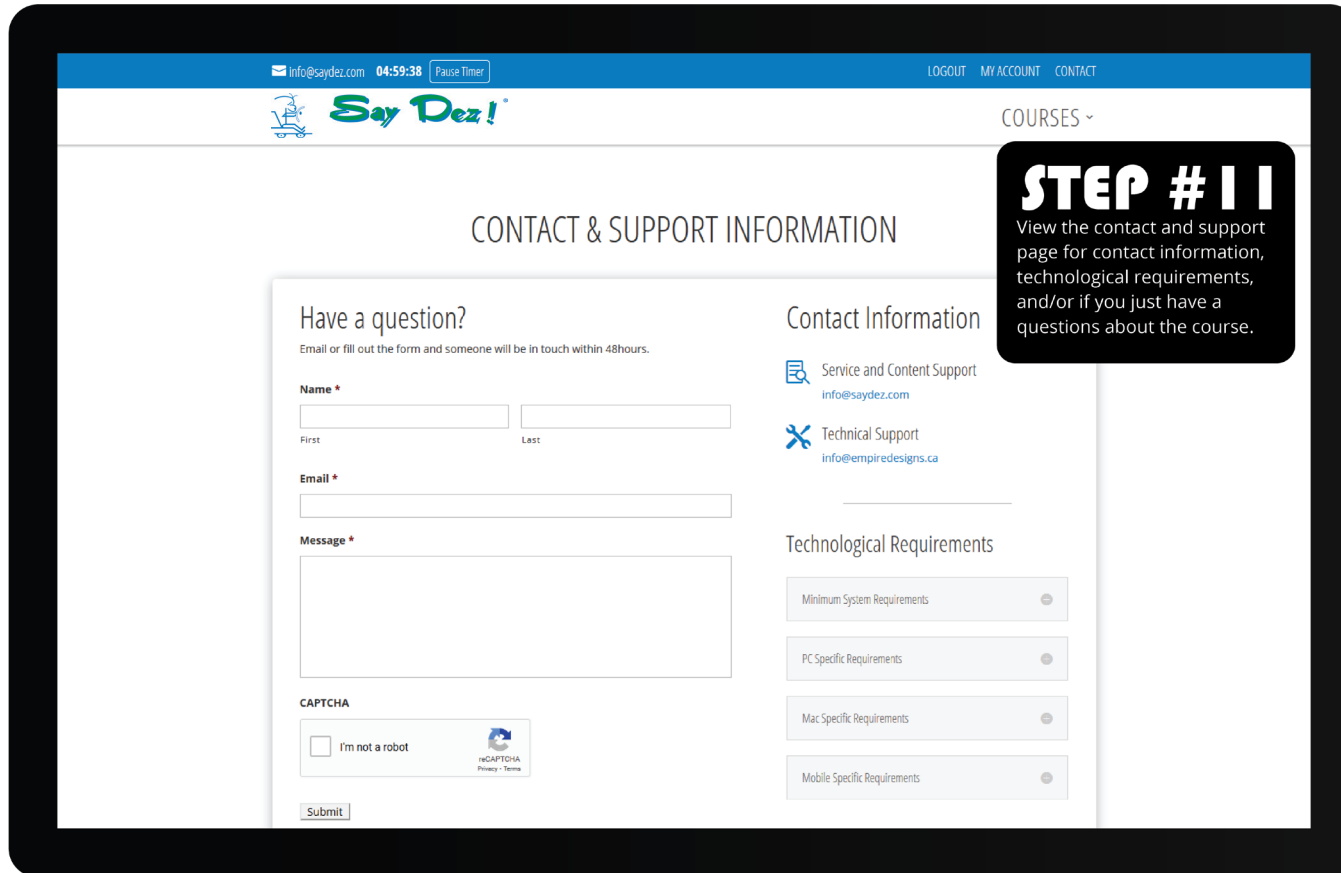

Review Terms & Conditions

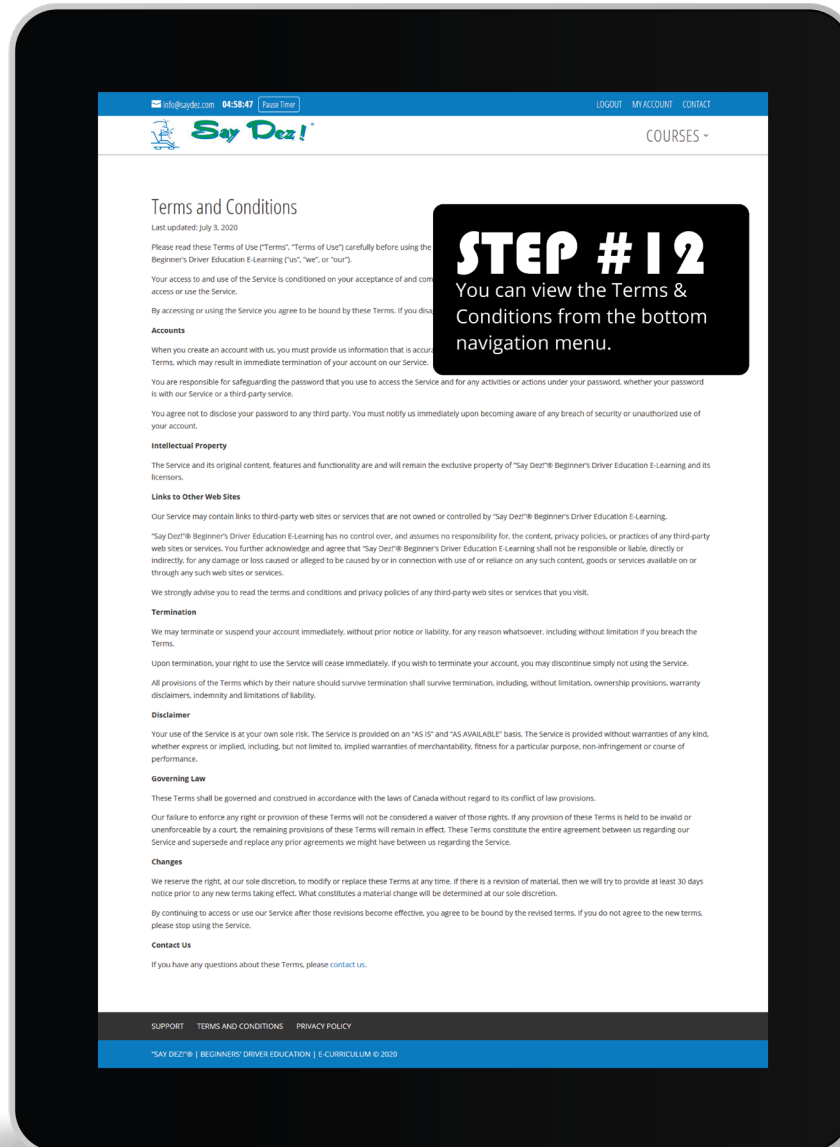

Review Privacy Policy



Start Course!

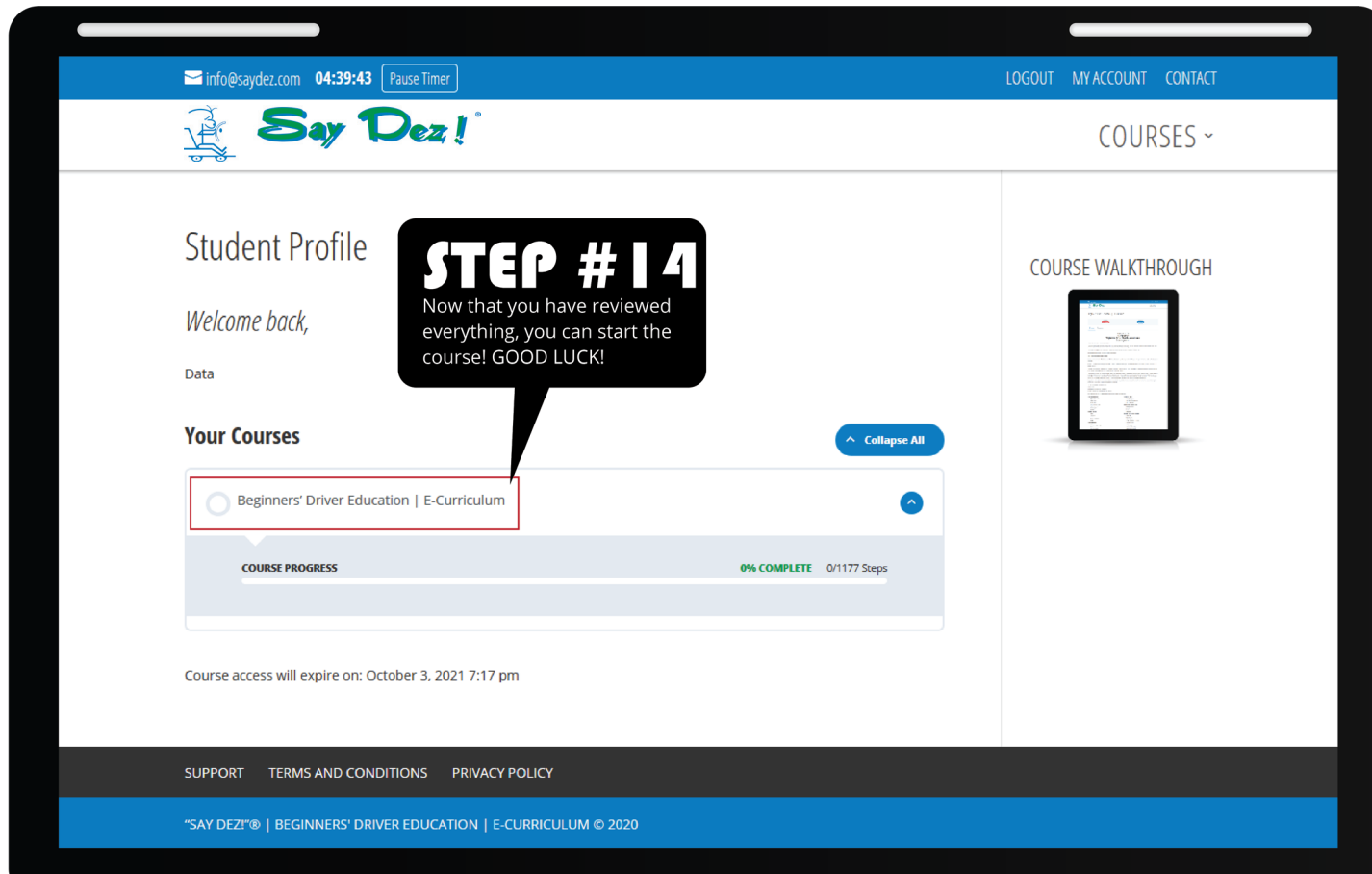

Choose 1st Module

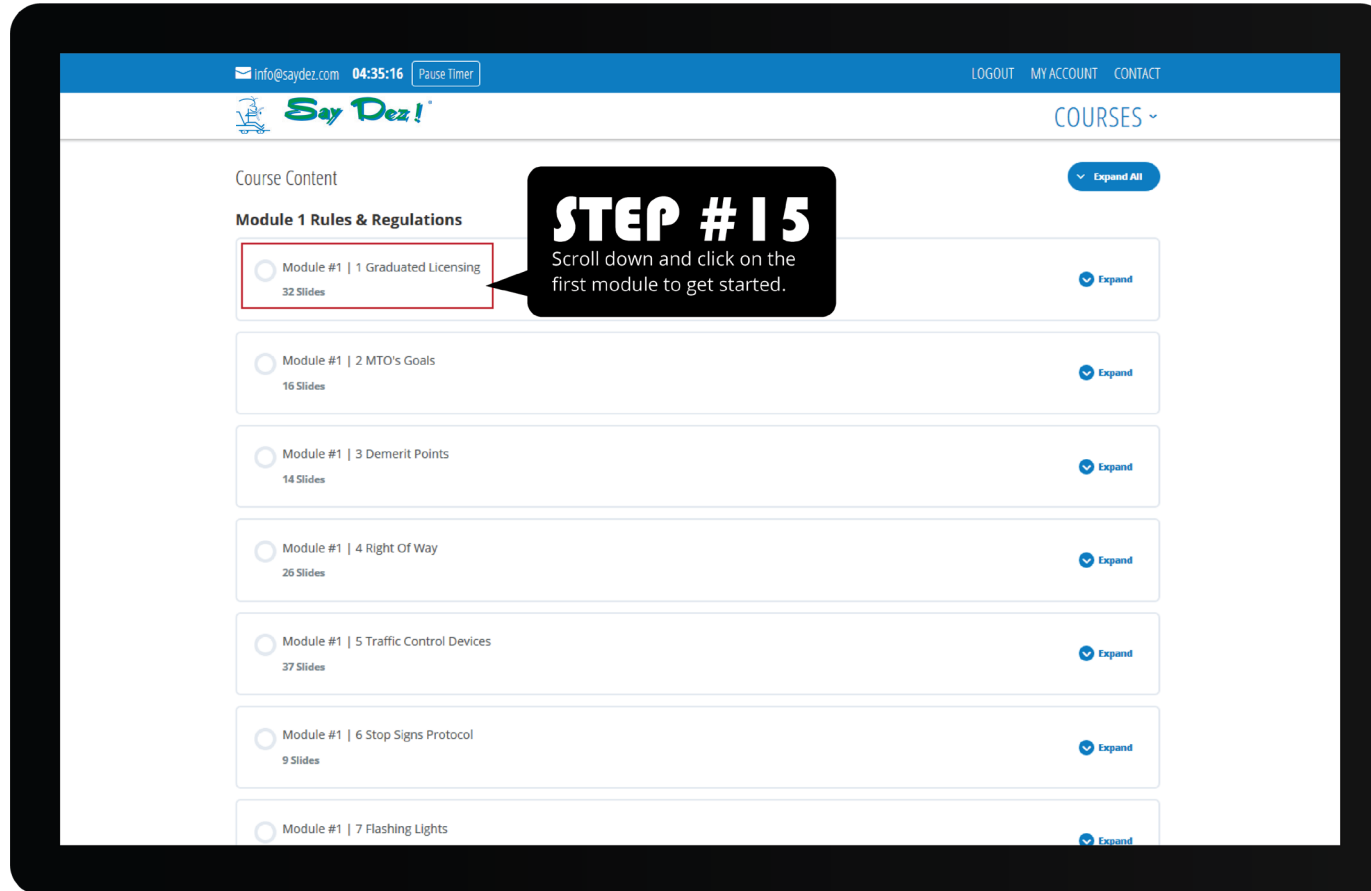

View Slides

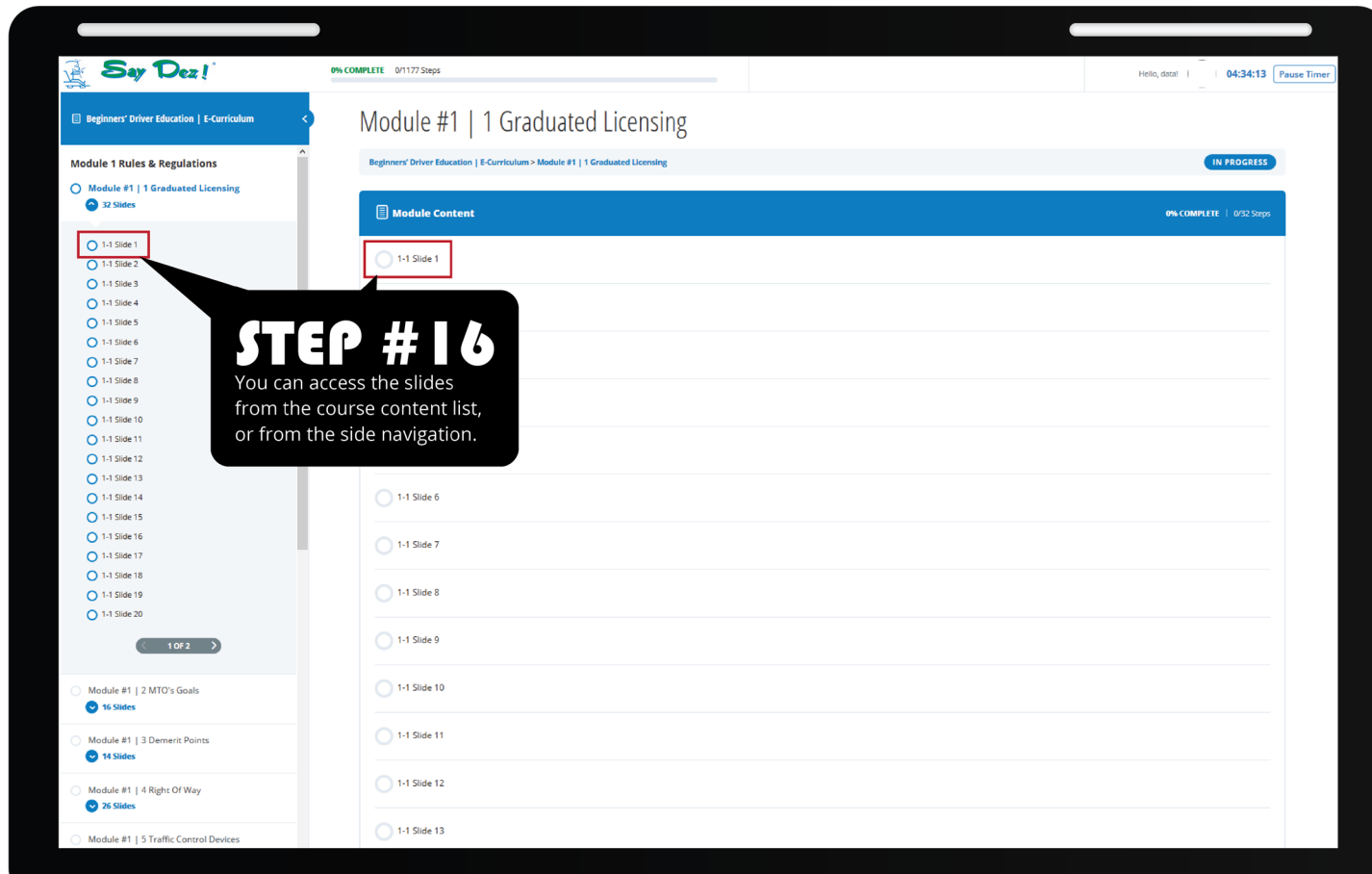

Review Content

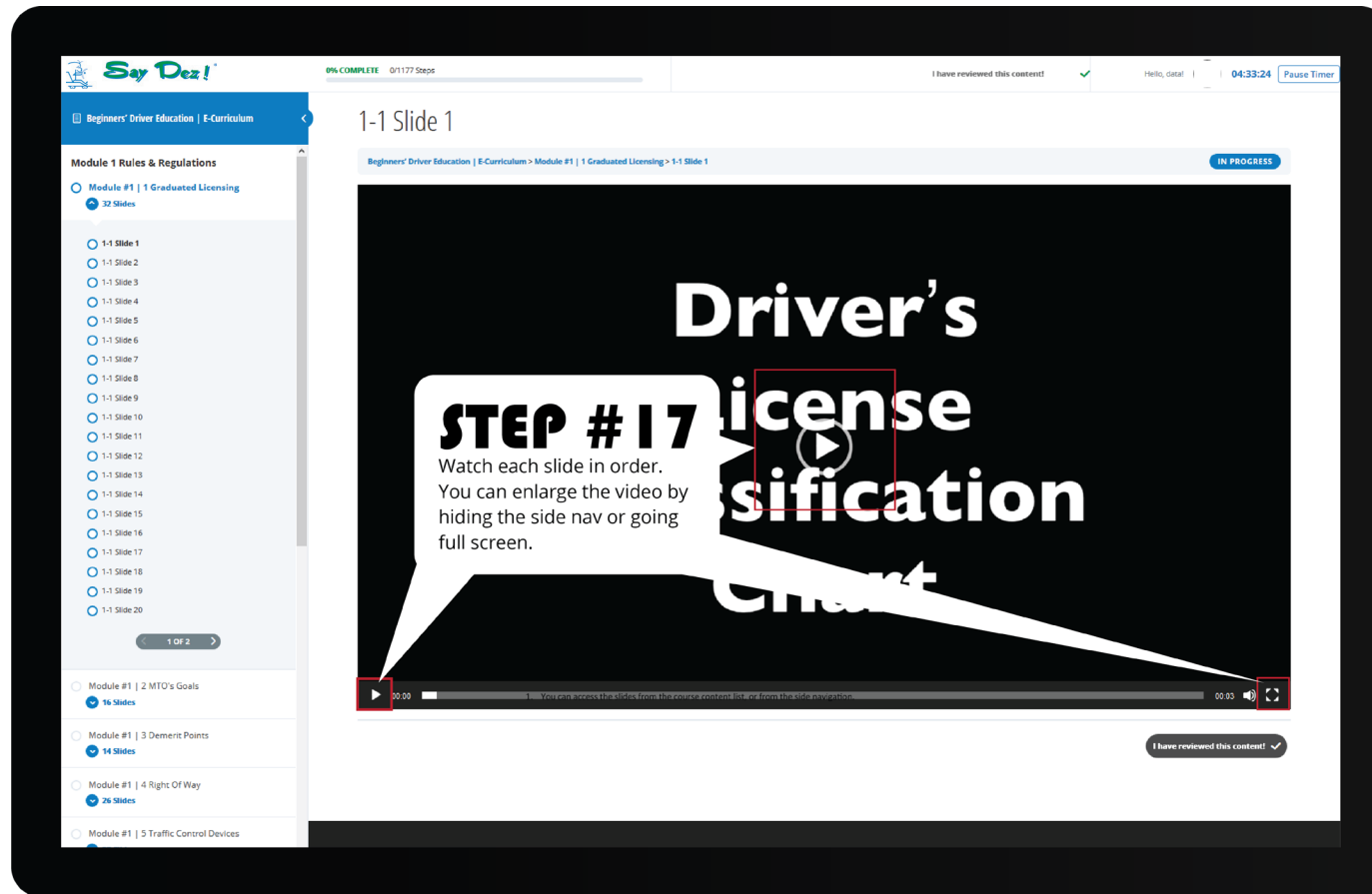

Mark Complete

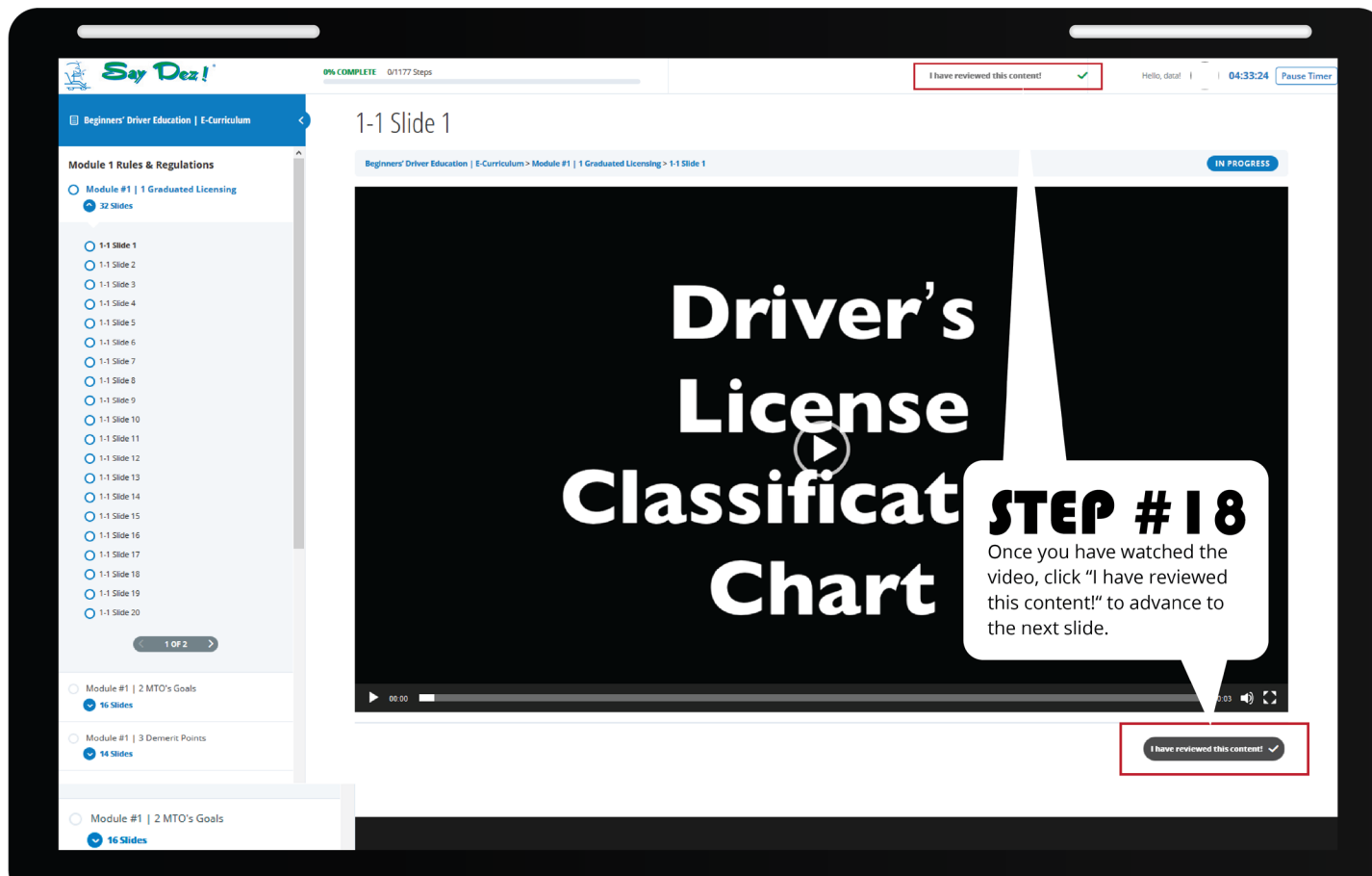

No Skipping

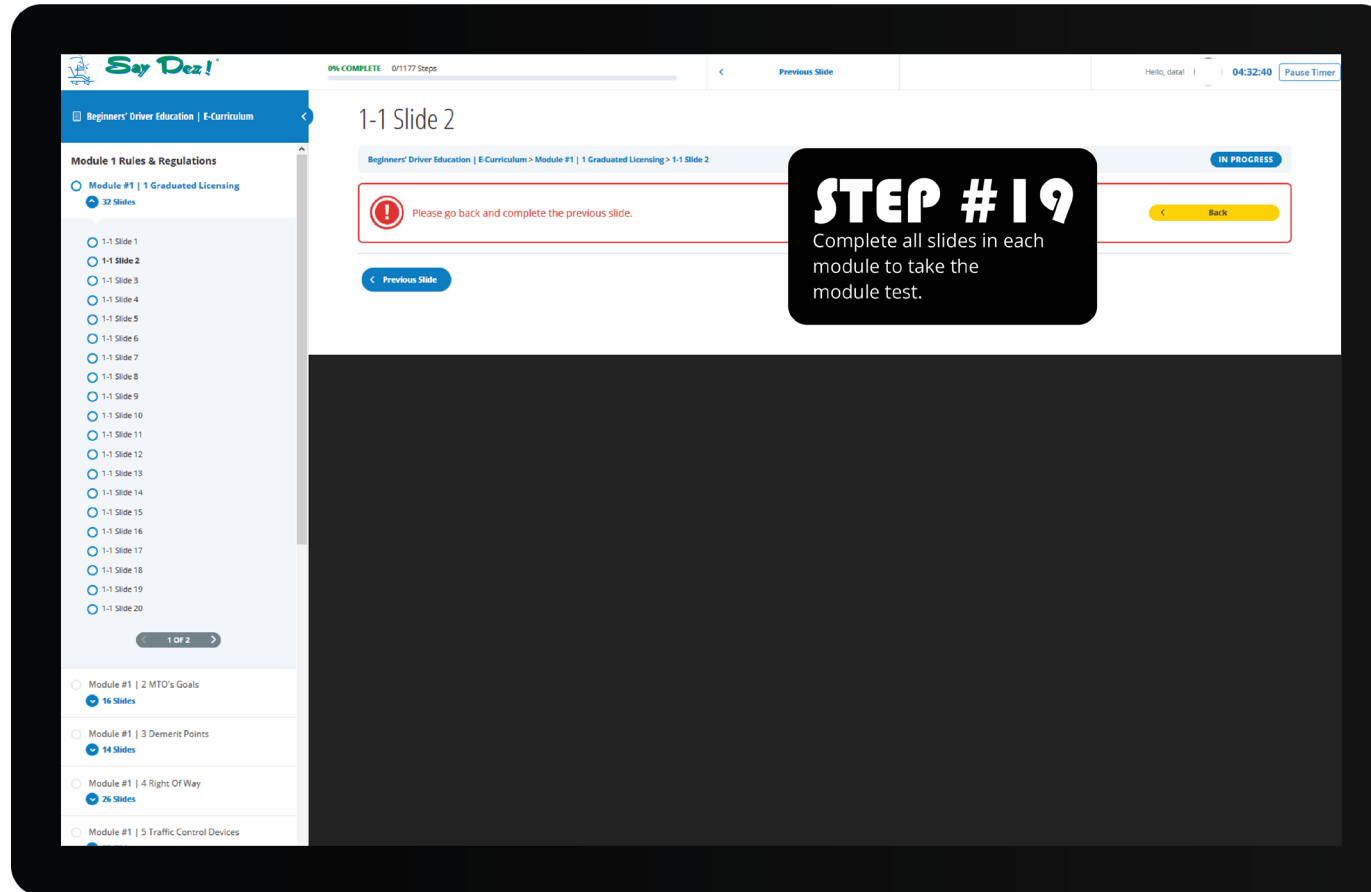

Take Test

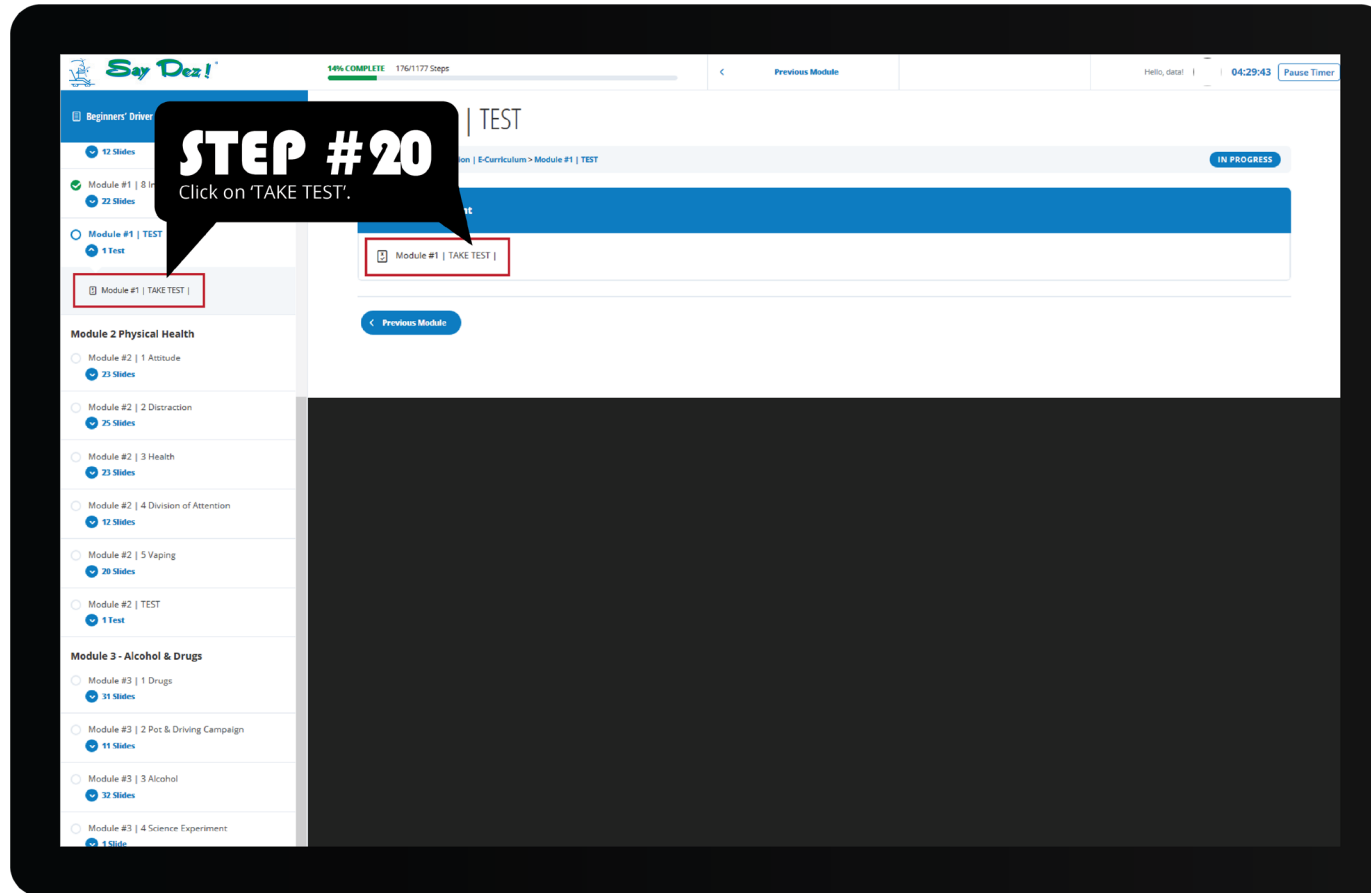

Confirm ID

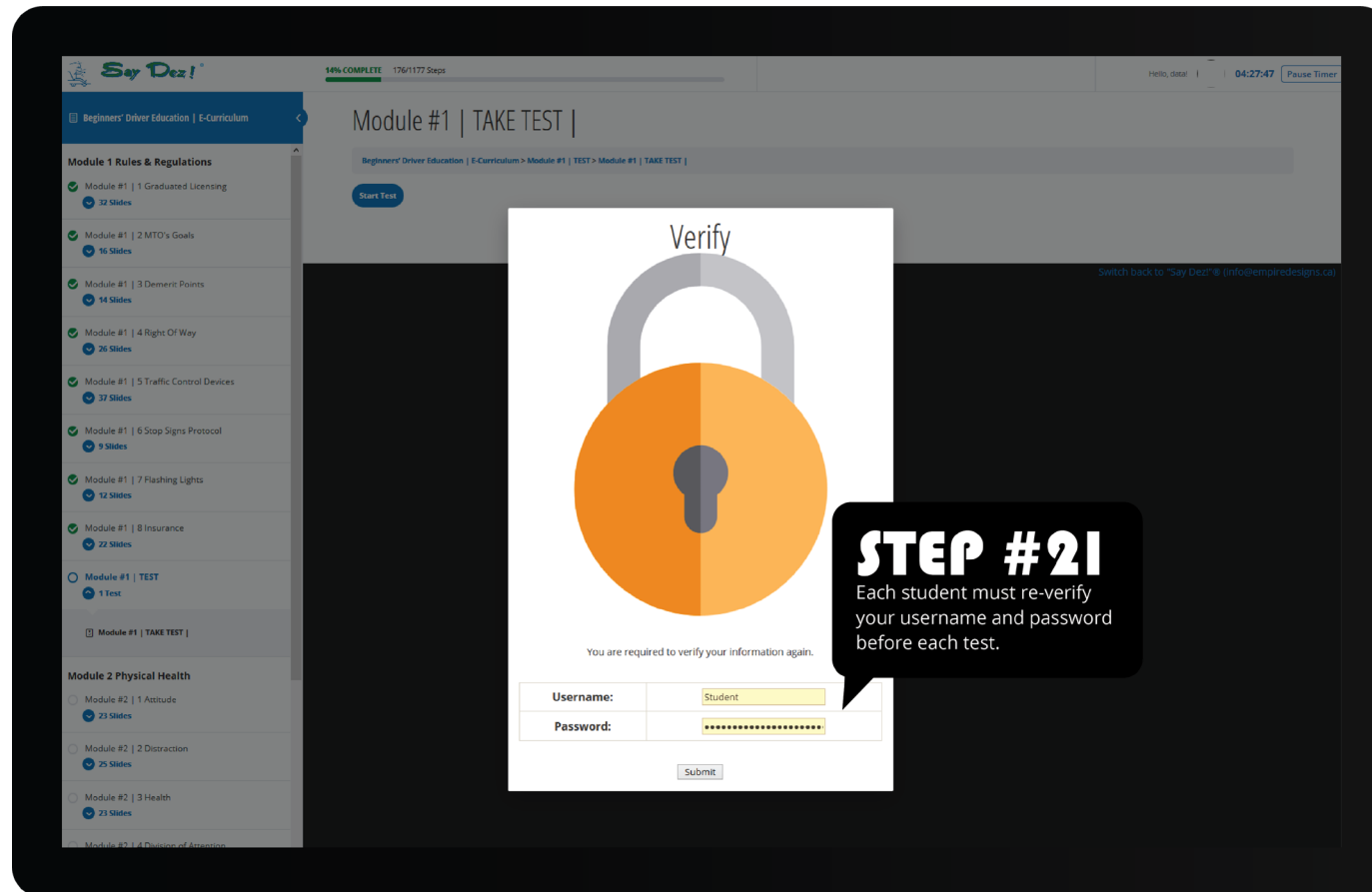

Start Test

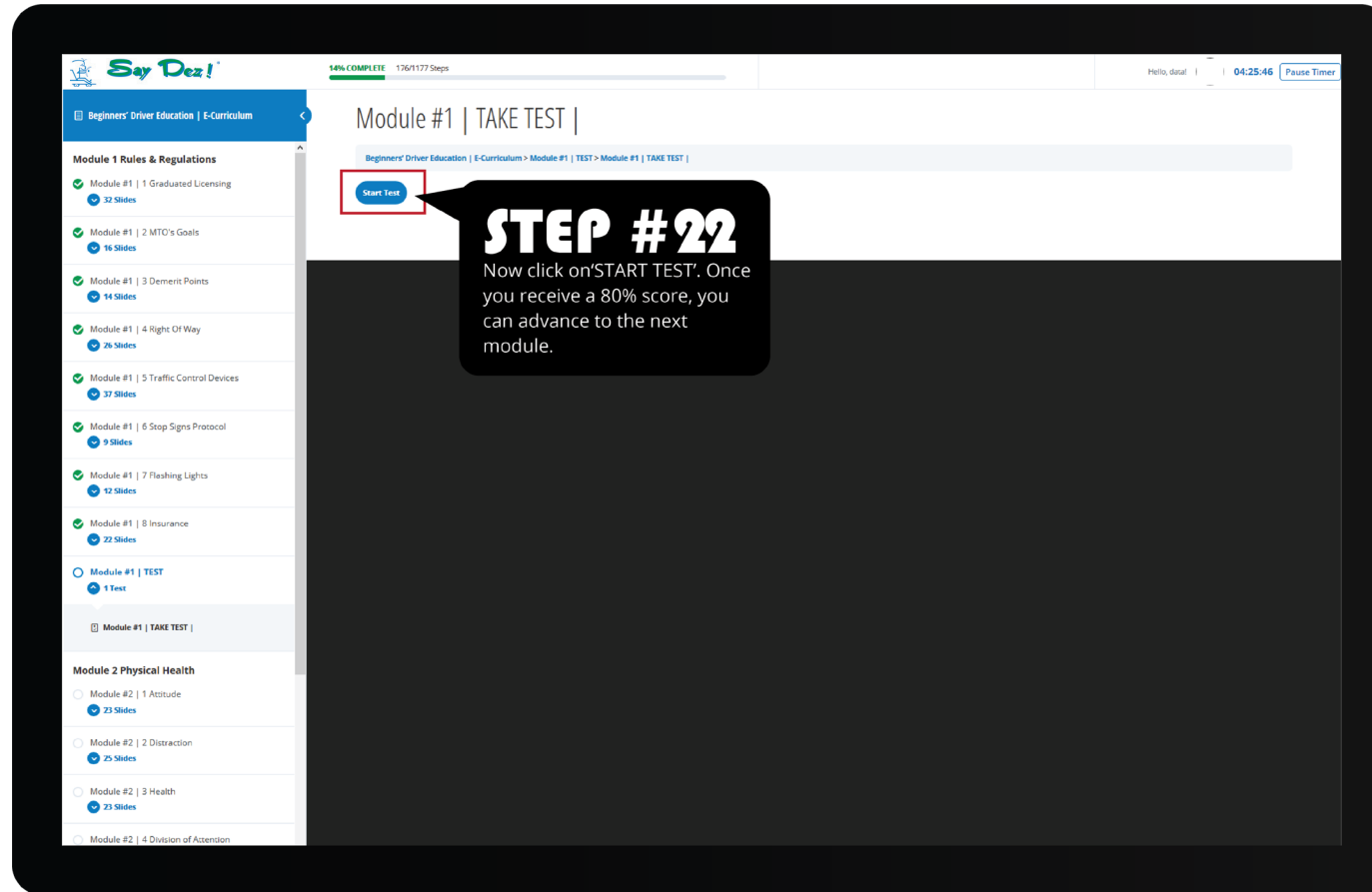

Pause Timer

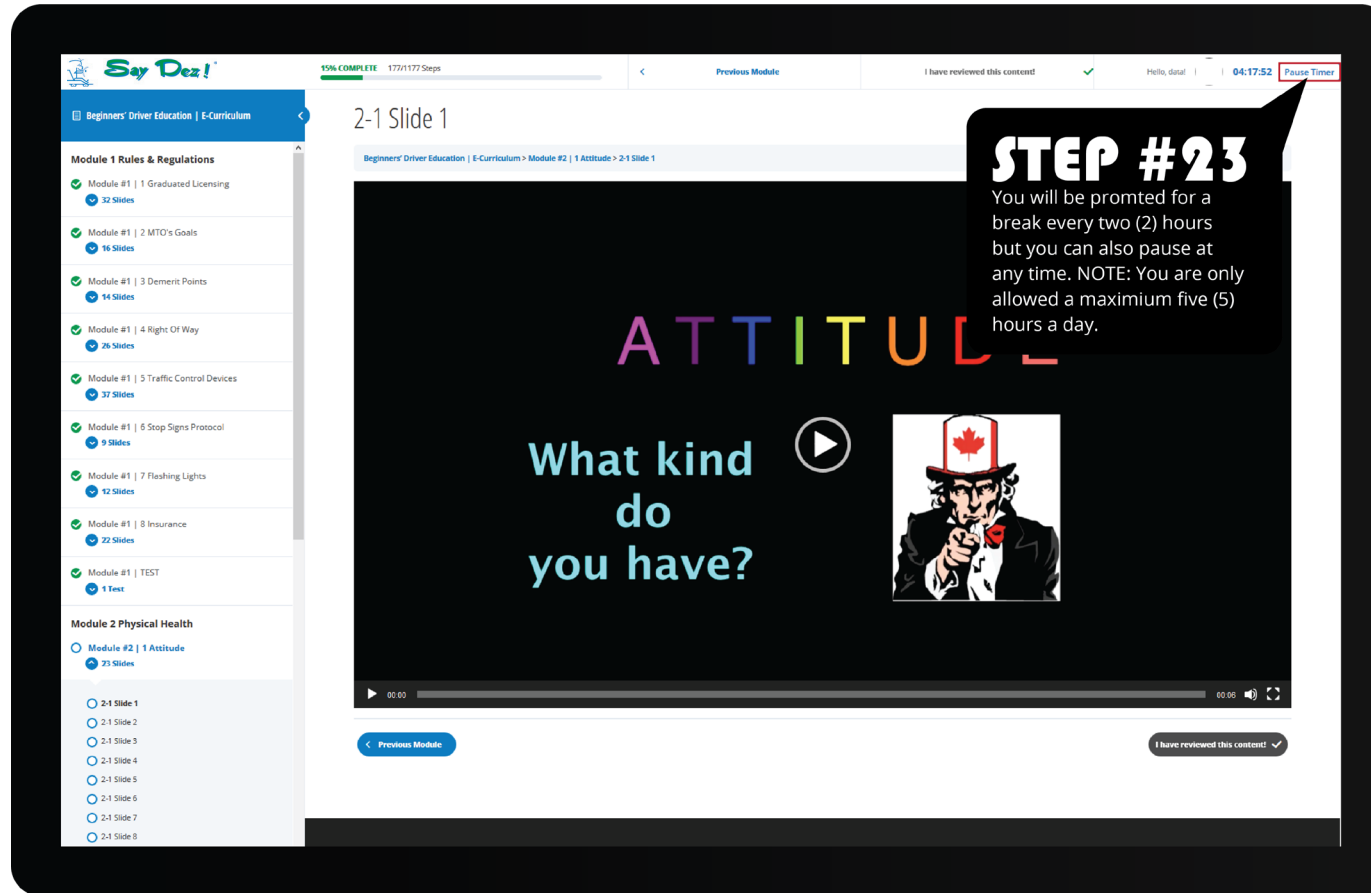

Continue



Breaks



Auto Logout Inactivity

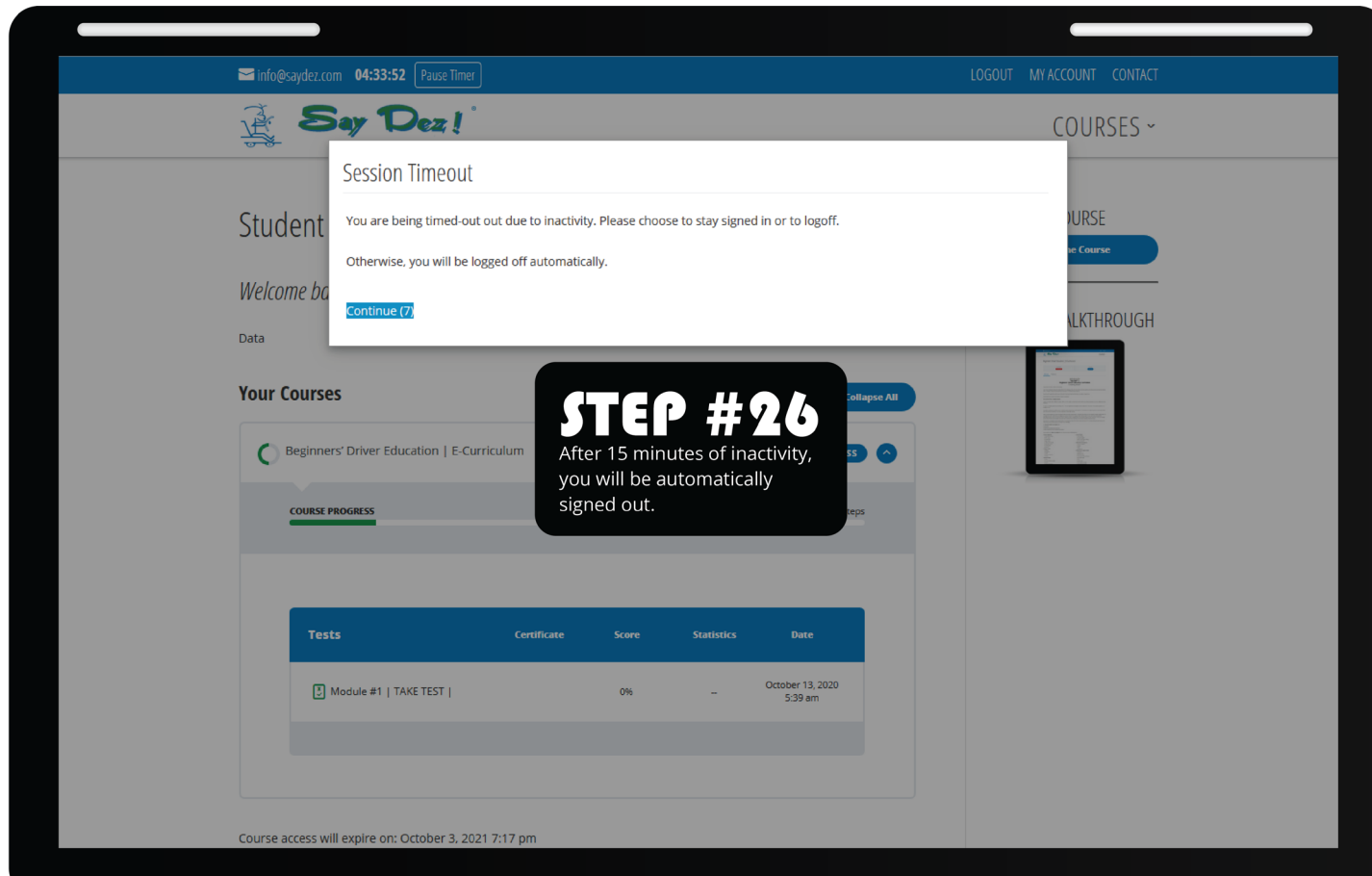

Random Validation

The screenshot shows a web application interface for 'Say Dez!'. A central modal window titled 'Verify' is displayed, featuring a large orange padlock icon. Below the icon, the text reads: 'Hi, You are required to verify your information again.' At the bottom of the modal is a form with two fields: 'Username:' with the value 'Student' and 'Password:' with a masked password '.....'. The background of the website is dimmed, showing a 'Student Profile' section with a 'Welcome back,' message, a 'Your Courses' section with a progress bar for 'Beginners' Driver Education | E...', and a 'Tests' section with a 'Module #1 | TAKE TEST |' button. A 'Resume Course' button is also visible on the right side of the page.

STEP #27
Within 2 hours of studying,
you will be required to verify
your username and
password.

5 Hour Daily Limit



Feedback

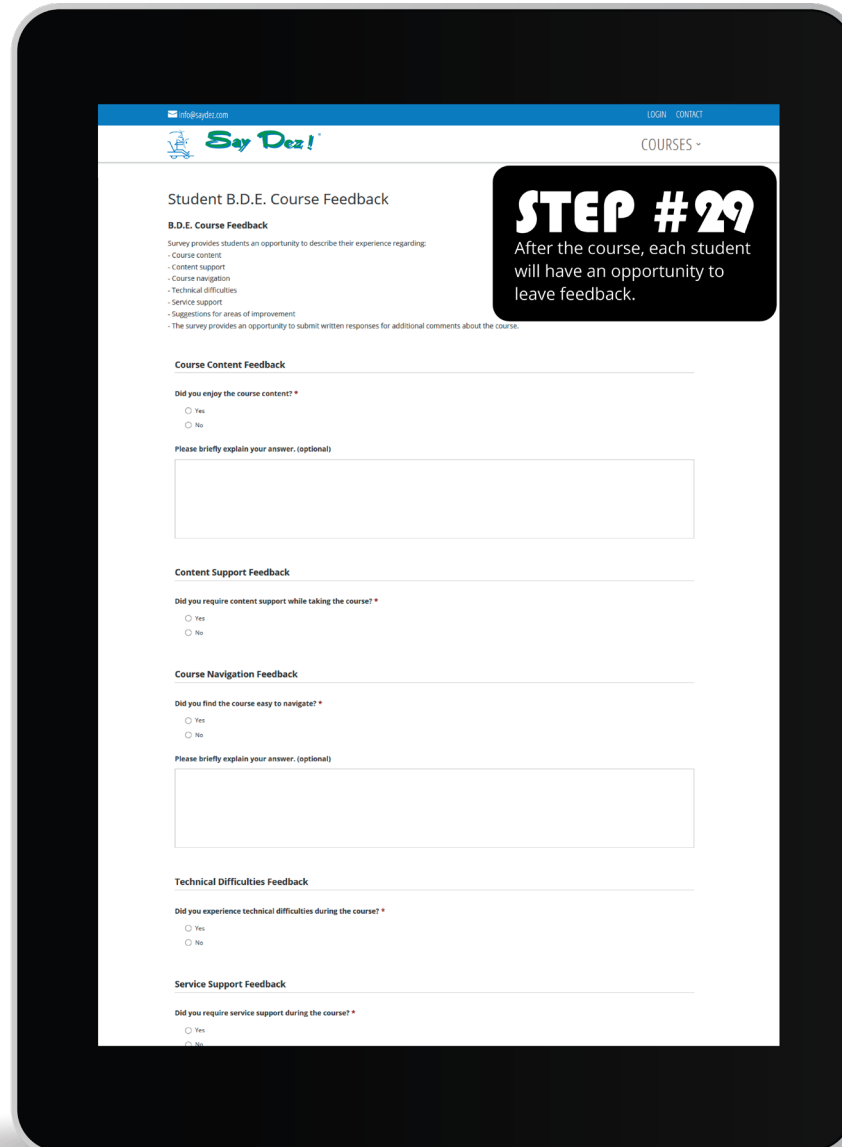

info@saydez.com LOGIN CONTACT

Say Dez! COURSES

Student B.D.E. Course Feedback

B.D.E. Course Feedback

Survey provides students an opportunity to describe their experience regarding:

- Course content
- Content support
- Course navigation
- Technical difficulties
- Service support
- Suggestions for areas of improvement

The survey provides an opportunity to submit written responses for additional comments about the course.

STEP #29
After the course, each student will have an opportunity to leave feedback.

Course Content Feedback

Did you enjoy the course content? *

Yes
 No

Please briefly explain your answer, (optional)

Content Support Feedback

Did you require content support while taking the course? *

Yes
 No

Course Navigation Feedback

Did you find the course easy to navigate? *

Yes
 No

Please briefly explain your answer, (optional)

Technical Difficulties Feedback

Did you experience technical difficulties during the course? *

Yes
 No

Service Support Feedback

Did you require service support during the course? *

Yes
 No



Say Dez!®

Email: info@saydez.com
Web: e-curriculum.saydez.com